

17/20 HP

12,5 ÷ 14,7 kW

schaft detail

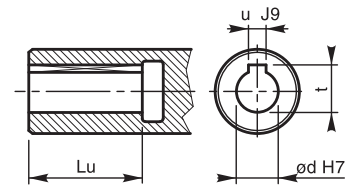

MOTOR TYPE	POWER		$\varnothing d H7$	Lu	t	u J9	weight
	HP	kW					
MI-100/17	17	12,5	19	30,5	21,8	6	28,5
			24	36	27,3	8	
MI-100/20	20	14,7	19	30,5	21,8	6	30,5
			24	36	27,3	8	

For information not included in this data sheet please consult GMV

Three phase 2 poles motor type MI-100
(12,5 ÷ 22,0 kW - 50 Hz)

table :	05.072
date :	21/04/2008
revision :	
page :	1/1

GMV